

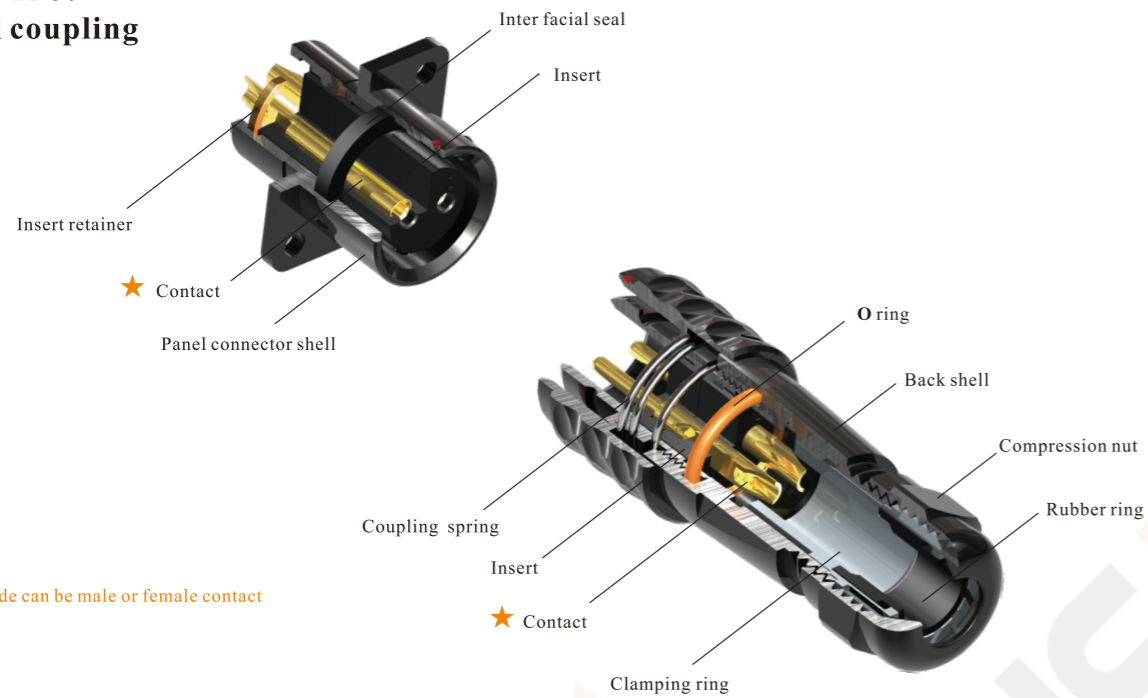

- SA Series IP67
- Push-pull coupling



★ Each side can be male or female contact

Material and spec

Coupling	Push-pull
Shell material	Anodized aluminium
Insert material	PPS, max temperature 260 °C
Contact material	Brass with gold plating
Termination	Solder: SA6, SA8, SA10, SA12, SA16, SA20, SA24, SA28 Crimp: SA16, SA20, SA24, SA28 Screw: SA20, SA24, SA28
Cable outer diameter range	SA6: I:2-3mm, II:3-4mm SA12: I: 4-6.5mm , II: 5-8mm SA24:10-14mm SA8: I:3-4mm, II: 4-5mm SA16: I: 5-8mm , II: 8-12mm SA28:I:9-13mm, II:13-16mm SA10:I:3-4mm, II:4-6.5mm SA20: I: 5-9mm, II: 8-12mm
IP rating	IP67
Mating cycle	500, USB:1000
Temperature range	-40°C ~+85°C; SA24 Data:-20°C ~+70°C
Insulation resistance	2000 MΩ

SA6 Series



Cable connector
Mate with SA611, SA612, SA615

SA610 / P SA610 / S
Male contact

- Colour:
B: Black
S: Silver
L: Blue (special order)
G: Green (special order)
R: Red (special order)
- Cable outer diameter range
I: 2-3mm, II:3-4mm
- Number of contact
- Female contact

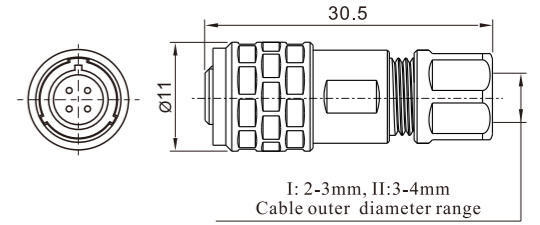

In-line cable connector
Mate with SA610

SA611 / P SA611 / S

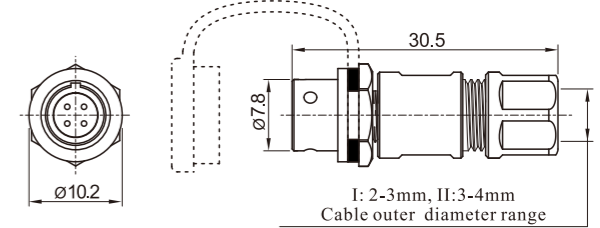

Rear-nut mount
Mate with SA610

SA612 / P SA612 / S

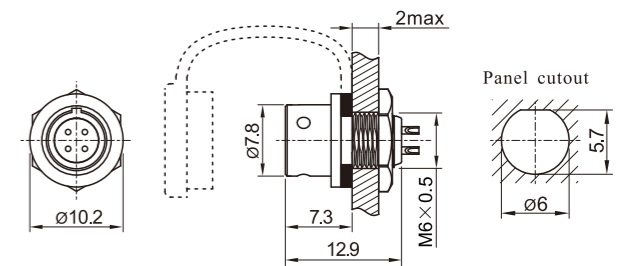

Front-nut mount
Mate with SA610

SA615 / P SA615 / S

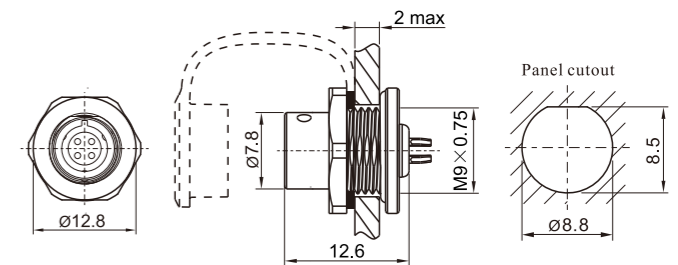

Solder contact spec

Number of contact	2	3	4	5
Male contact face view				
Rated current (A)	3	3	3	3
Contact diameter(mm)	Ø0.6×2	Ø0.6×3	Ø0.6×4	Ø0.6×5
Rated voltage (AC.V)	30	30	30	30
Test voltage(AC.V) 1 min	500	500	500	500
Contact resistance (mΩ)	10	10	10	10
Wire size (mm ² /AWG)	≤0.5/20	≤0.5/20	≤0.5/20	≤0.5/20

SA8 Series

SA
8



Cable connector
Mate with SA811, SA812,
SA815

SA810 / P SA810 / S

Male contact

- Colour:
B: Black
S: Silver
L: Blue (special order)
G: Green (special order)
R: Red (special order)
- Cable outer diameter range
I: 3-4mm, II: 4-5mm
- Number of contact
- Female contact

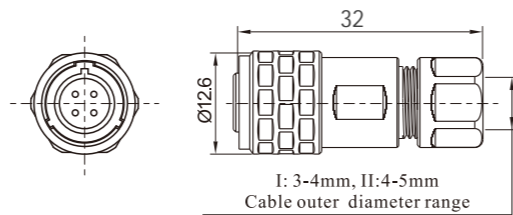

In-line cable connector
Mate with SA810

SA811 / P SA811 / S

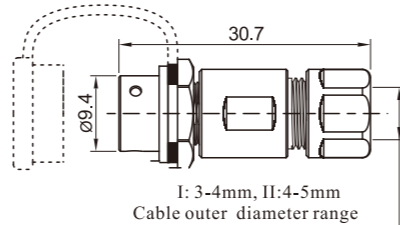

Rear-nut mount
Mate with SA810

SA812 / P SA812 / S

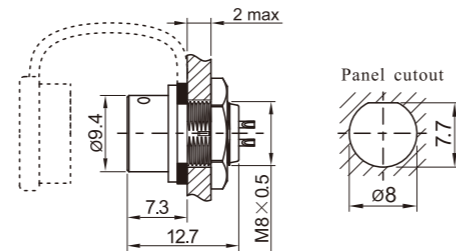

Front-nut mount
Mate with SA810

SA815 / P SA815 / S

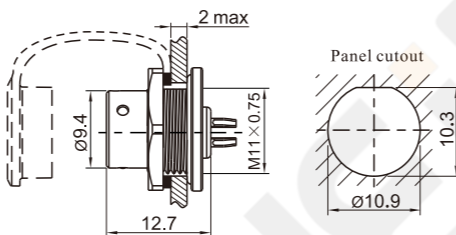
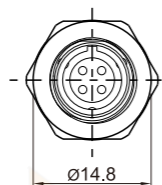

Solder contact spec

Number of contact	2	3	4	6	8
Male contact face view					
Rated current (A)	5	5	3	3	3
Contact diameter(mm)	Ø1×2	Ø1×3	Ø0.6×4	Ø0.6×6	Ø0.6×8
Rated voltage (AC.V)	125	125	30	30	30
Test voltage(AC.V) 1 min	1000	1000	500	500	500
Contact resistance(mΩ)	5	5	10	10	10
(mm /AWG) Wire size(mm ² /AWG)	≤0.75/18	≤0.75/18	≤0.5/20	≤0.5/20	≤0.5/20

SA10 Series

SA
10



Cable connector
Mate with SA1011, SA1012,
SA1015

SA1010 / P SA1010 / S

Male contact

- Colour:
B: Black
S: Silver
L: Blue (special order)
G: Green (special order)
R: Red (special order)
- Cable outer diameter range
I: 3-4mm, II: 4-6.5mm
- Number of contact
- Female contact

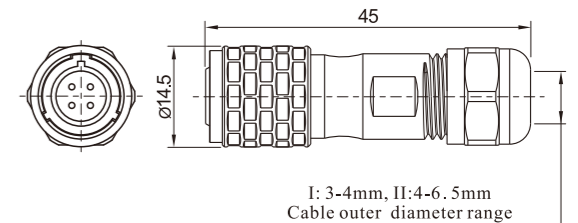

In-line cable connector
Mate with SA1010

SA1011 / P SA1011 / S

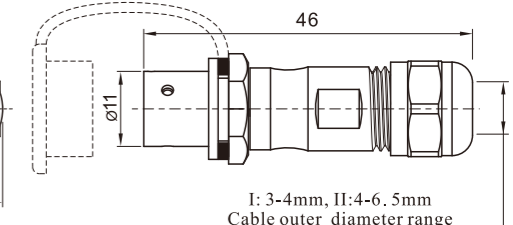

Rear-nut mount
Mate with SA1010

SA1012 / P SA1012 / S

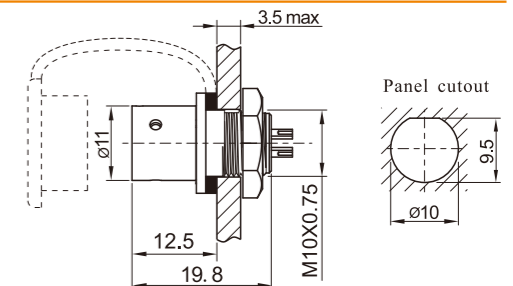
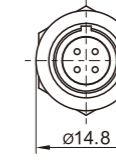

Front-nut mount
Mate with SA1010

SA1015 / P SA1015 / S

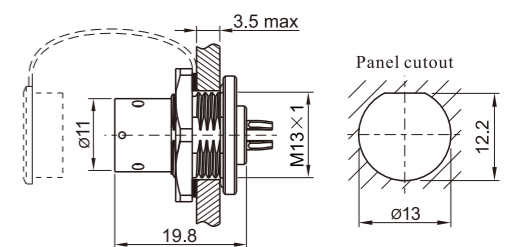

Solder contact spec

Number of contact	2	3	4	5
Male contact face view				
Rated current (A)	5	5	3	3
Contact diameter(mm)	Ø1×2	Ø1×3	Ø0.7×4	Ø0.7×5
Rated voltage (AC.V)	180	180	125	125
Test voltage(AC.V) 1 min	1000	1000	1000	1000
Contact resistance(mΩ)	5	5	10	10
Wire size(mm ² /AWG)	≤0.75/18	≤0.75/18	≤0.5/20	≤0.5/20

SA12 Series

SA
12



Cable connector
Mate with SA1211, SA1212
SA1213, SA1215

SA1210/P — SA1210/S
Male contact
Female contact
Number of contact

Colour:
B: Black
S: Silver
L: Blue (special order)
G: Green (special order)
R: Red (special order)
Cable outer diameter
I: 4-6.5mm, II: 5-8mm

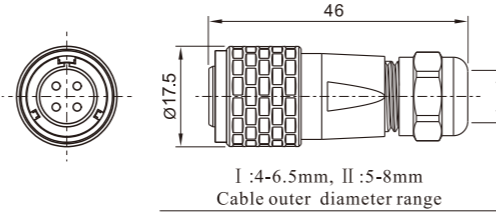

In-line cable connector
Mate with SA1210

SA1211/P — SA1211/S

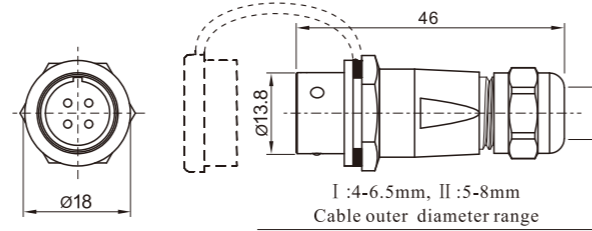

Rear-nut mount
Mate with SA1210

SA1212/P — SA1212/S
Number of contact

Colour:
B: Black
S: Silver
L: Blue (special order)
G: Green (special order)
R: Red (special order)

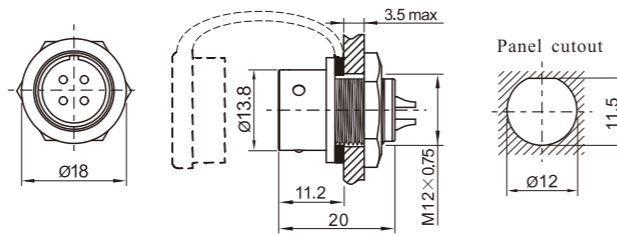

Square flange
Mate with SA1210

SA1213/P — SA1213/S

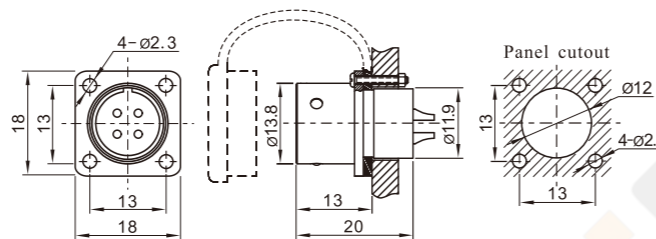

Front-nut mount
Mate with SA1210

SA1215/P — SA1215/S

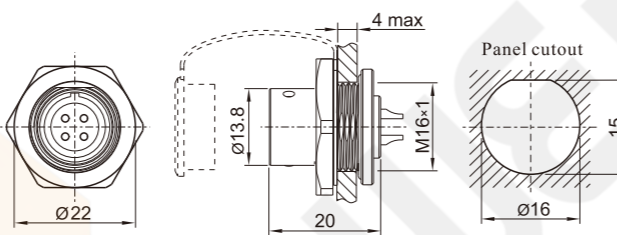

Solder contact spec

Number of contact	2	3	4	5	6	7	9
Male contact face view							
Rated current (A)	13	13	5	5	5	5	3
Contact diameter	∅1.6X2	∅1.6X3	∅1X4	∅1X5	∅1X6	∅1X7	∅0.7X9
Rated voltage (AC.V)	250	250	200	180	125	125	125
Test voltage(AC.V) 1 min	1500	1500	1500	1000	1000	1000	1000
Contact resistance (mΩ)	2.5	2.5	5	5	5	5	10
Wire size (mm²/AWG)	≤2/14	≤2/14	≤0.75/18	≤0.75/18	≤0.75/18	≤0.75/18	≤0.5/20

SA16 Series

SA
16



Cable connector
Mate with SA1611, SA1612,
SA1613, SA1615

SA1610/P — SA1610/S
Male contact
Female contact
Number of contact
Cable outer diameter
I: 5-8mm, II: 8-12mm

1: solder, 3: crimp
Colour:
B: Black
S: Silver
L: Blue (special order)
G: Green (special order)
R: Red (special order)

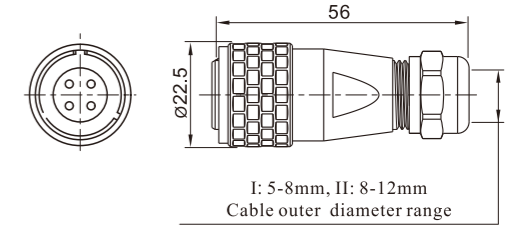

In-line cable connector
Mate with SA1610

SA1611/P — SA1611/S

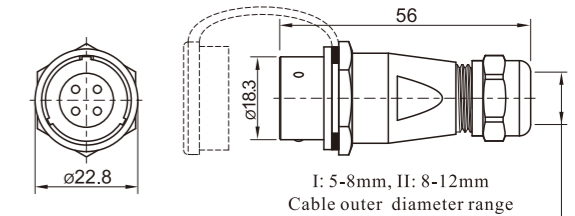

Rear-nut mount
Mate with SA1610

SA1612/P — SA1612/S
Number of contact
Colour

1: solder, 3: crimp

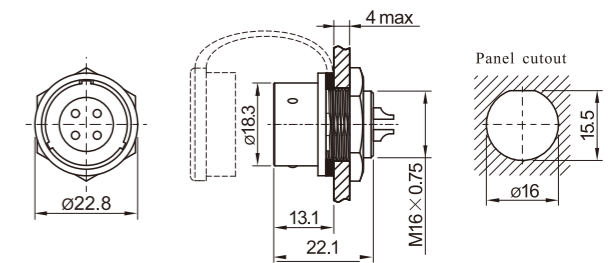

Square flange
Mate with SA1610

SA1613/P — SA1613/S

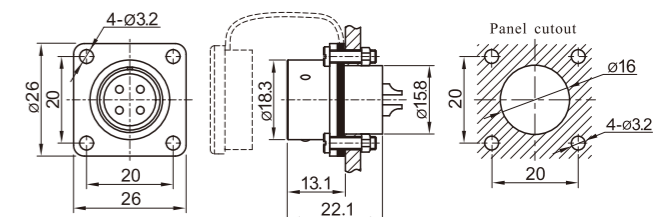

Front-nut mount
Mate with SA1610

SA1615/P — SA1615/S

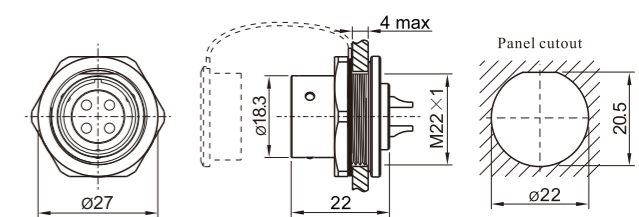

Solder contact spec

★ Crimp contact spec see P20

Number of contact	2	3	4	2B	3B	4B	5	7	9	10
Male contact face view										
Rated current (A)	10	10	5	15	15	15	5	5	5	5
Contact diameter (mm)	∅1.5X2	∅1.5X3	∅1X4	∅2X2	∅2X3	∅2X4	∅1X5	∅1X7	∅1X9	∅1X10
Rated voltage (AC.V)	500	500	500	500	500	500	500	400	400	400
Test voltage(AC.V) 1 min	1500	1500	1500	1500	1500	1500	1500	1200	1200	1200
Contact resistance (mΩ)	2.5	2.5	5	2.5	2.5	2.5	5	5	5	5
Wire size (mm²/AWG)	≤2/14	≤2/14	≤0.75/18	≤2/14	≤2/14	≤2/14	≤0.75/18	≤0.75/18	≤0.75/18	≤0.75/18

SA20 Series

SA
20



Cable connector
Mate with SA2011, SA2012,
SA2013, SA2015

SA2010/P --- SA2010/S
Male contact
Female contact
Number of contact

1: solder, 2: screw, 3: crimp
Colour:
B: Black
S: Silver
L: Blue (special order)
G: Green (special order)
R: Red (special order)
Cable outer diameter range
I: 5-9mm, II: 8-12mm

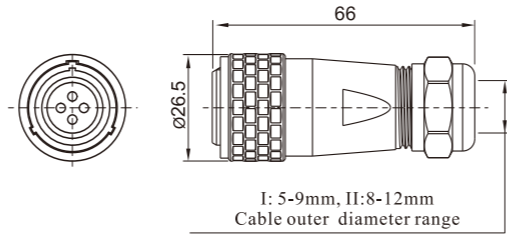

In-line cable connector
Mate with SF2010

SA2011/P --- SA2011/S

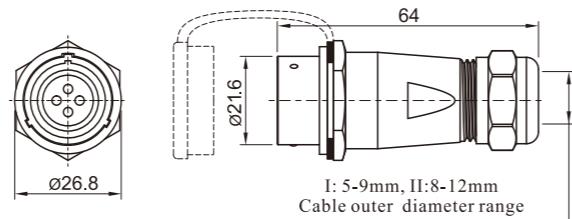

Rear-nut mount
Mate with SA2010

SA2012/P --- SA2012/S

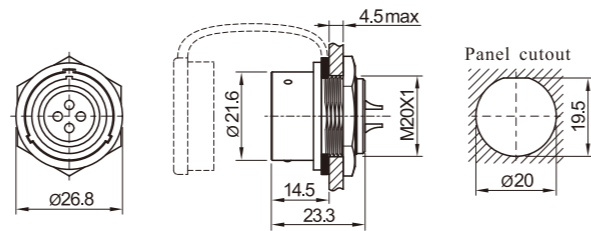

Square flange
Mate with SA2010

SA2013/P --- SA2013/S

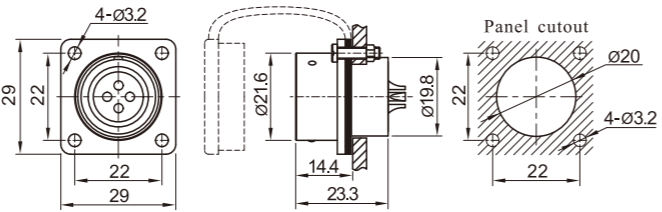

Front-nut mount
Mate with SA2010

SA2015/P --- SA2015/S

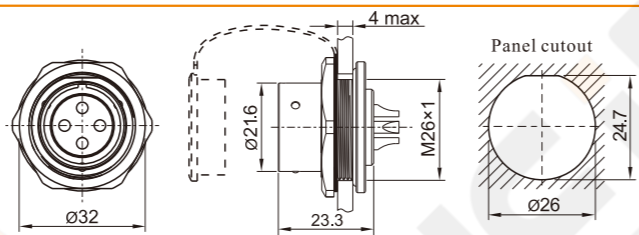

Solder contact spec

★Crimp contact spec see P20

★Screw contact spec see P21

Number of contact	2	3	4	5	6	6B	7	8	9	12	15
Male contact face view											
Rated current (A)	25	25	25	10	25	30	10	10	5	5	5
Contact diameter(mm)	Ø2.5X2	Ø2.5X3	Ø2.5X4	Ø1.5X5	Ø2.5X4 Ø1X2	Ø3X2 Ø1X4	Ø1.5X7	Ø1.5X8	Ø1X9	Ø1X12	Ø1X15
Rated voltage (AC.V)	500	500	500	500	500	500	500	500	400	400	400
Test voltage(AC.V) 1 min	1500	1500	1500	1500	1500	1500	1500	1500	1200	1200	1200
Contact resistance (mΩ)	1	1	1	2.5	1	1	2.5	2.5	5	5	5
Termination	solder / screw	solder / screw	solder / screw	solder	solder	solder	solder	solder	solder	solder	solder
Wire size for solder (mm ² / AWG)	≤4/11	≤4/11	≤4/11	≤2/14	≤4/11 ≤0.75/18	≤4/11 ≤0.75/18	≤2/14	≤2/14	≤0.75/18	≤0.75/18	≤0.75/18
Wire size for screw termination (mm ² / AWG)	≤1.5/15	≤1.5/15	≤1.5/15	/	/	/	/	/	/	/	/

SA24 Series

SA
24



Cable connector
Mate with SA2411, SA2412,
SA2413

SA2410/P --- SA2410/S
Male contact
Female contact
Number of contact

1: solder, 2: screw, 3: crimp
Colour:
B: Black
S: Silver
L: Blue (special order)
G: Green (special order)
R: Red (special order)

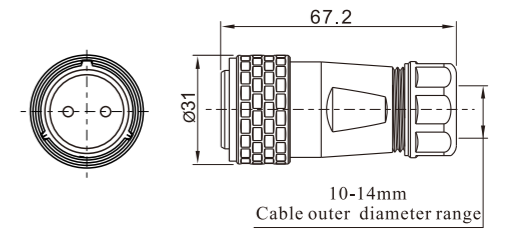

In-line cable connector
Mate with SA2410

SA2411/P --- SA2411/S

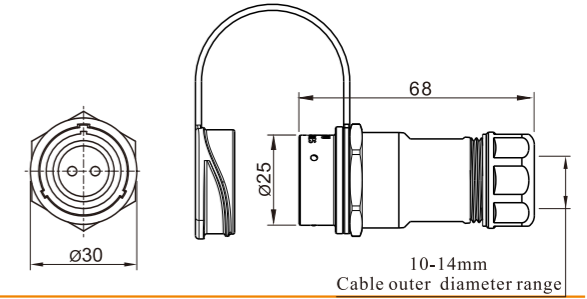

Rear-nut mount
Mate with SA2410

SA2412/P --- SA2412/S

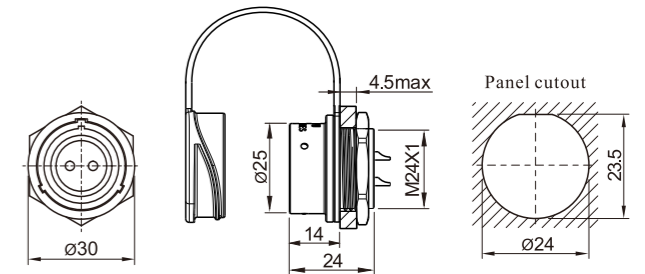

Square flange
Mate with SA2410

SA2413/P --- SA2413/S

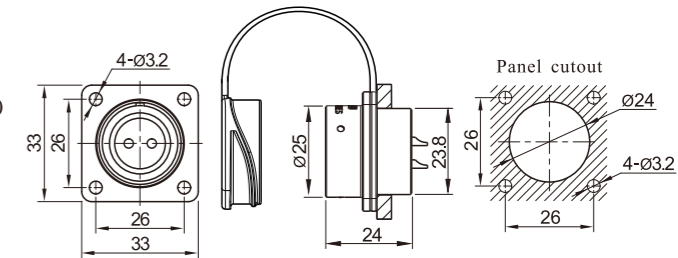

Solder contact spec

★Crimp contact spec see P20

★Screw contact spec see P21

Number of contact	2	3	4	9	10	12	12B	19
Male contact face view								
Rated current (A)	25	25	25	5	10	10	5	5
Contact diameter(mm)	Ø2.5X2	Ø2.5X3	Ø2.5X4	Ø1X5 Ø2.5X4	Ø1.5X10	Ø1.5X12	Ø1X9 Ø3X3	Ø1X19
Rated voltage (AC.V)	500	500	500	500	500	500	500	400
Test voltage(AC.V) 1 min	1500	1500	1500	1500	1500	1500	1500	1200
Contact resistance (mΩ)	1	1	1	5	2.5	2.5	5	5
Insulation resistance (MΩ)	2000	2000	2000	2000	2000	2000	2000	2000
Wire size (mm ² / AWG)	≤4/11	≤4/11	≤4/11	≤0.75/18 ≤4/11	≤2/14	≤2/14	≤0.75/18 ≤4/11	≤0.75/18
Wire size for screw termination	≤1.5/15	≤1.5/15	≤1.5/15	/	/	/	/	/

SA28 Series

SA
28



Cable connector
Mate with SA2811, SA2812,
SA2813, SA2815

SA2810/P --- SA2810/S
Male contact
Female contact
Number of contact

1: solder, 2: screw, 3: crimp
Colour:
B: Black
S: Silver
L: Blue (special order)
G: Green (special order)
R: Red (special order)
Cable outer diameter range
I: 9-13mm, II: 13-16mm

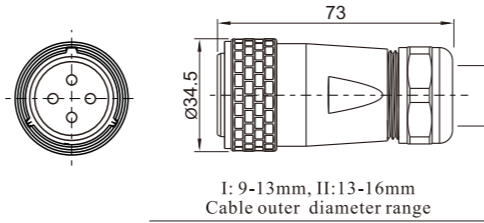

In-line cable connector
Mate with SA2810

SA2811/P --- SA2811/S

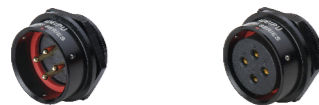
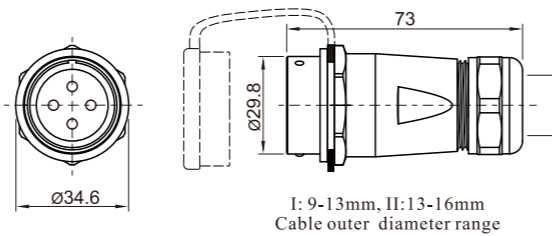

Rear-nut mount
Mate with SA2810

SA2812/P --- SA2812/S

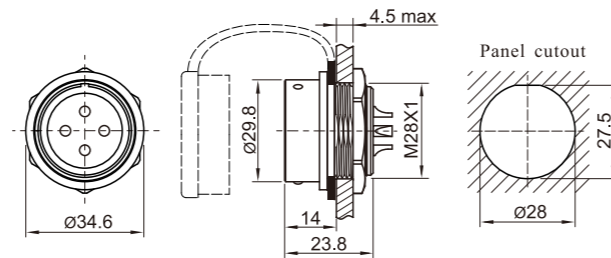

Square flange
Mate with SA2810

SA2813/P --- SA2813/S

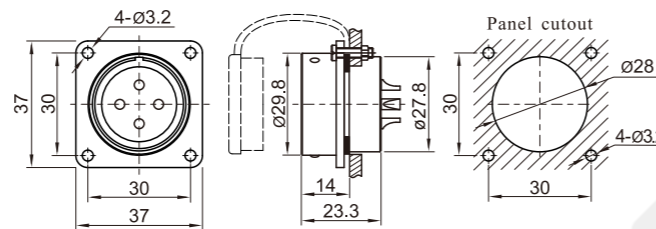

Front-nut mount
Mate with SA2810

SA2815/P --- SA2815/S

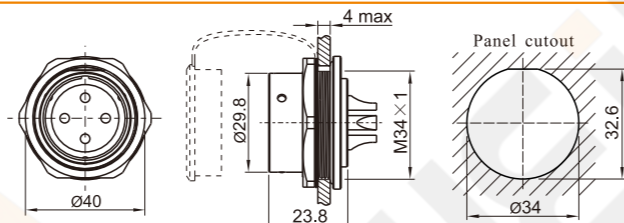

Solder contact spec

★ Crimp contact spec see P20

★ Screw contact spec see P21

Number of contact	2	3	4	7	8	8B	9	10	10B	12	16	17	20	24	26	35
Male contact face view																
Rated current (A)	50	50	25	25	25	60.5	25.5	25	10	10	10	10	5	5	5	5
Contact diameter(mm)	Ø3.5X2	Ø3.5X3	Ø2.5X4	Ø2.5X7	Ø2.5X8	Ø5X2 Ø1X6	Ø2.5X4 Ø1X5	Ø2.5X10	Ø1.5X10	Ø1.5X12	Ø1.5X16	Ø1.5X17	Ø1X20	Ø1X24	Ø1X26	Ø1X35
Rated voltage (AC.V)	500	500	500	500	500	500 400	500	500	500	500	500	500	400	400	400	400
Test voltage(AC.V) 1 min	1500	1500	1500	1500	1500	1500	1500	1500	1500	1500	1500	1500	1200	1200	1200	1200
Contact resistance(mΩ)	0.5	0.5	1	1	1	0.5.5	1.5	1	2.5	2.5	2.5	2.5	5	5	5	5
Termination	solder / screw	solder / screw	solder / screw	solder / screw	solder / screw	solder	solder	solder / screw	solder	solder	solder	solder	solder	solder	solder	solder
Wire size (mm²/AWG)	≤10/7	≤10/7	≤4/11	≤4/11	≤4/11	≤16/5 ≤0.75/18	≤4/11 ≤0.75/18	≤4/11	≤2/14	≤2/14	≤2/14	≤2/14	≤0.75/18	≤0.75/18	≤0.75/18	≤0.75/18
Wire size for screw termination	≤6/10	≤6/10	≤1.5/15	≤1.5/15	≤1.5/15	/	/	≤1.5/15	/	/	/	/	/	/	/	/

SA24 Series

NEW

SA24



Plug with LC adapter
Mate with SA2411, SA2412, SA2413

SA2410/PLC

Wire length:
0.5m
1.0m
1.5m
2.0m
3.0m

Colour:
B: Black
S: Silver
L: Blue (special order)
G: Green (special order)
R: Red (special order)

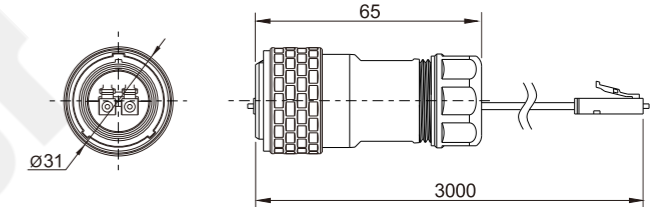

★ Wire length can be customized



Receptacle with LC adapter
Mate with SA2410

SA2411/SLC

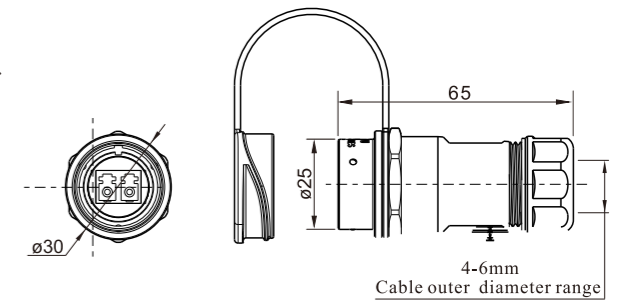

Rear-nut mount receptacle
with LC adapter
Mate with SA2410

SA2412/SLC

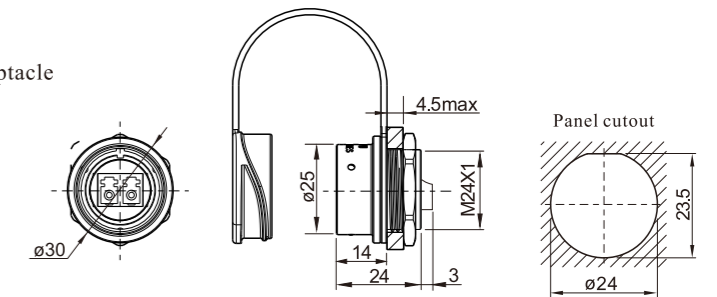

Square flange receptacle
with LC adapter
Mate with SA2410

SA2413/SLC

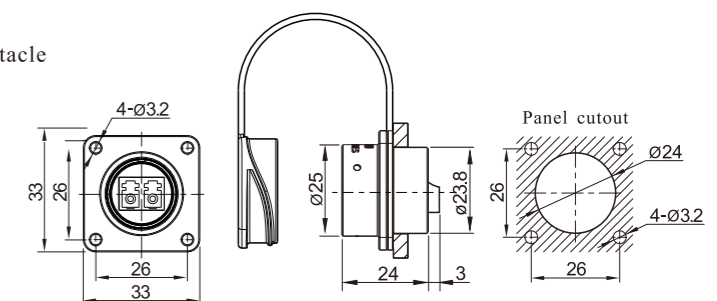

SA24 Series



SA24



RJ45 Plug
Mate with SA2411, SA2412, SA2413

SA2410/PRJ45

- Colour:
- B: Black
- S: Silver
- L: Blue (special order)
- G: Green (special order)
- R: Red (special order)

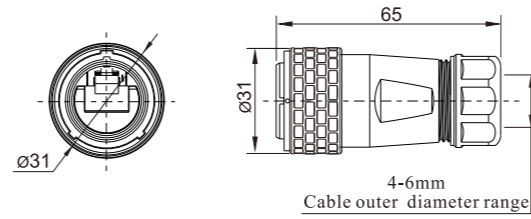

SA24 Series



SA24



USB3.0 Plug
Mate with SA2411, SA2412, SA2413

SA2410/PUSB3.0

- Wire length:
- 0.5m
- 1.0m
- 1.5m
- 2.0m
- 3.0m
- Colour:
- B: Black
- S: Silver
- L: Blue (special order)
- G: Green (special order)
- R: Red (special order)

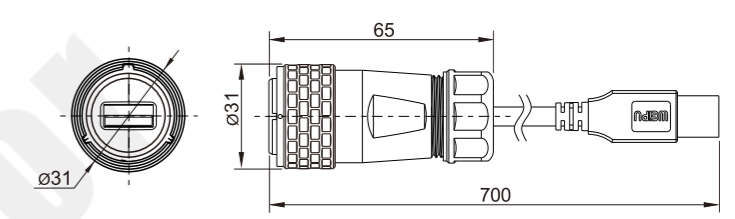

★ Wire length can be customized



RJ45 Receptacle
Mate with SA2410

SA2411/SRJ45

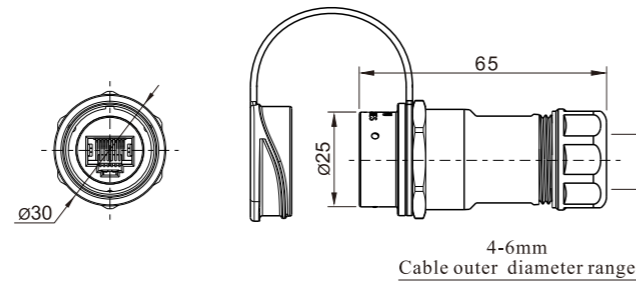

USB3.0 Receptacle
Mate with SA2410

SA2411/SUSB3.0

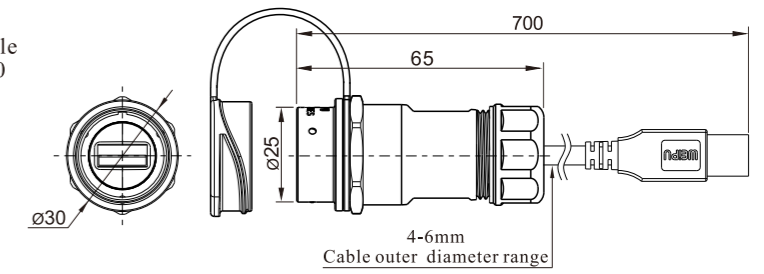

RJ45 Rear-nut mount receptacle
Mate with SA2410

SA2412/SRJ45

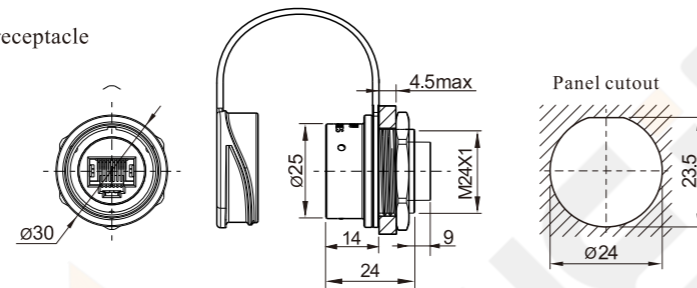

USB3.0 Rear-nut mount receptacle
Mate with SA2410

SA2412/SUSB3.0

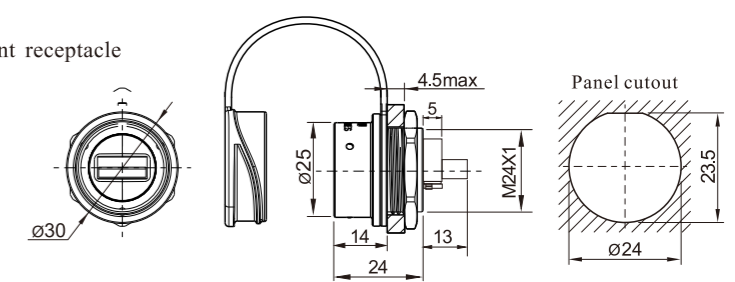

RJ45 Square flange receptacle
Mate with SA2410

SA2413/SRJ45

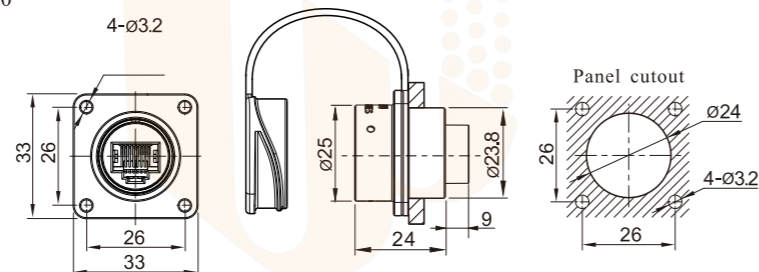

USB3.0 Square flange receptacle
Mate with SA2410

SA2413/SUSB3.0

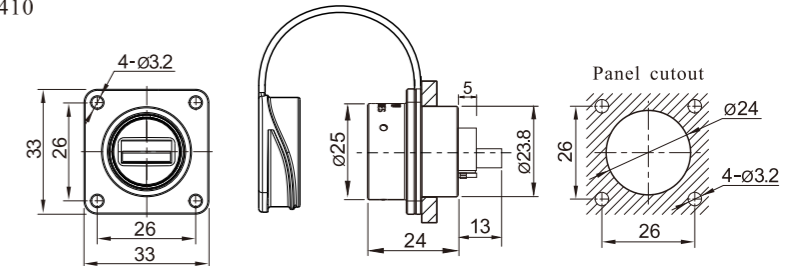

SA24 Series



SA24



HDMI2.0 Plug
Mate with SA2411, SA2412, SA2413

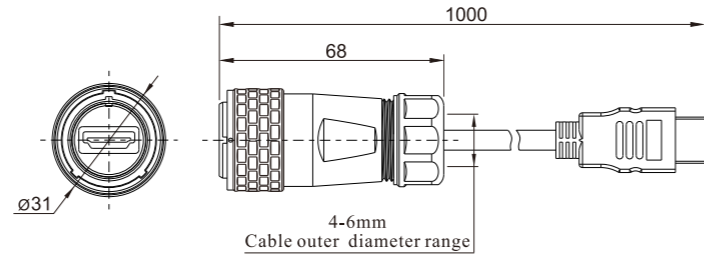

SA2410/PHDMI2.0

- Wire length:
- 0.5m
 - 1.0m
 - 1.5m
 - 2.0m
 - 3.0m
- Colour:
- B: Black
 - S: Silver
 - L: Blue (special order)
 - G: Green (special order)
 - R: Red (special order)

★ Wire length can be customized



HDMI2.0 Receptacle
Mate with SA2410

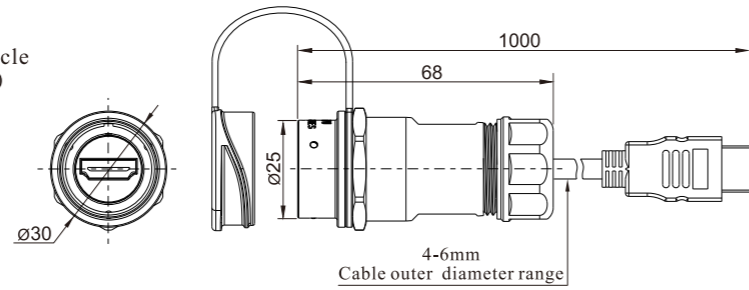

SA2411/SHDMI2.0

★ The cable length can be customized, but not more than 5 meters.



HDMI2.0 Rear-nut mount receptacle
Mate with SA2410

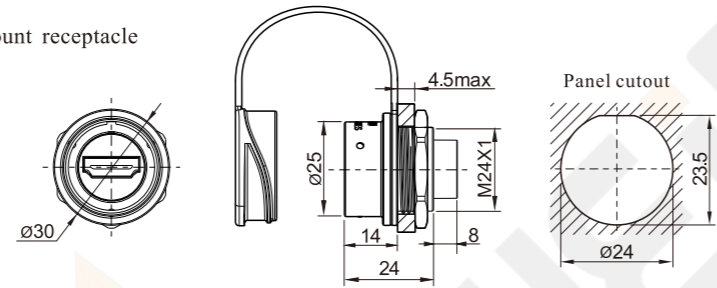

SA2412/SHDMI2.0



HDMI2.0 Square flange receptacle
Mate with SA2410

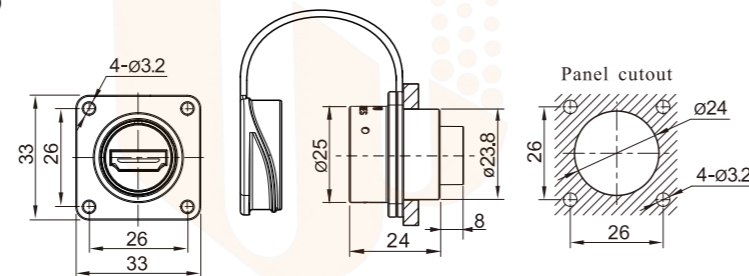

SA2413/SHDMI2.0

